

Powerdaylight® Ø35 cm ECO for flat roof - concrete

Construction detail based on: Rc Roof ≥ 6.3 m²·K/W U-value tube ≤ 0.7 W/m²·K QV10 value ≤ 0.625 dm³/s per m²

Powerdaylight® Ø35 cm
dome polycarbonate

Dome reflector for enhanced
light collection (attached to the
north side of the dome)

Dome lens

Sealing strip

ECO roof flashing

Flashing insulator

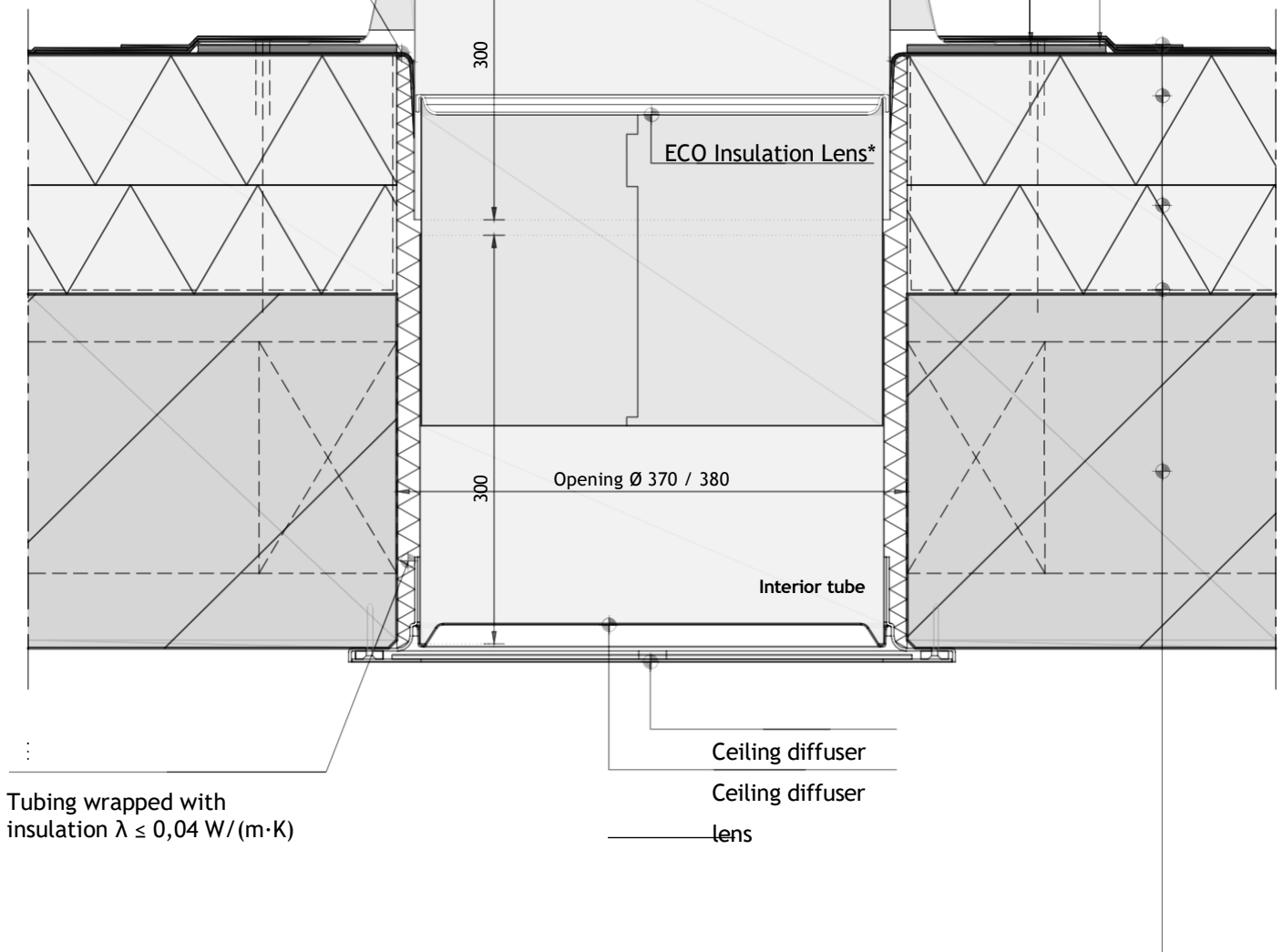

Tubing wrapped with
insulation $\lambda \leq 0,04 \text{ W/(m}\cdot\text{K)}$

Ceiling diffuser

Ceiling diffuser

lens

*ECO insulation lens is attached
to extension tube below