

Installation instructions

**Exterior (roof) components of 25 cm
and 35 cm (inc. Eco) systems with flat
roof flashing**

**Exterior (roof) components of 53 cm
system with flat roof flashing**

Version: 2025-02

Contents

Foreword	3
Safety.....	3
Guarantee.....	3
Disclaimer.....	3
Step 1 – Create openings.....	4
Step 2 – Fit the flashing insulator	4
Step 3 – Mount the roof flashing.....	4
Step 4 – Install system through roof flashing.....	4
Step 5 – Orientate the dome reflector	6
Step 6 – Fix the roof dome	6

Foreword

Safety

- Always observe the safety instructions for the materials and tools to be used.
- Always wear the appropriate personal protective equipment (gloves, safety goggles etc.).
- We would suggest that any roof works is completed by an experienced roofer.
- Always have any electrical works carried out by a certified electrician.
- Please note that the installation works is carried out at your own risk.

Warranty

- Non-electrical components are covered by a 10 year manufacturer's warranty against any manufacturing defects.
- Please retain the original proof of purchase to validate the product warranty.
- Any costs associated to the installation of any replacement parts covered under the warranty remain at the expense of the purchaser.
- Our terms and conditions are available upon request.

Disclaimer

Techcomlight Limited expressly disclaims any liability for any unexpected additional expense arising as a result of condensation or any water damage resulting from condensation, installation not in accordance with Techcomlight Limited's installation guide/s or any other external influences beyond the control of Techcomlight Limited. Techcomlight Limited cannot be held liable for damage to structures caused as a result of making openings and installing the product supplied. Techcomlight assumes no responsibility or obligation for the failure of an architect, contractor, installer or building owner to comply with all applicable laws, ordinances, building codes, energy codes, fire and safety codes and requirements, and adequate safety measures.

Installation instructions reserved. No rights can be derived from this publication.

Step 1 – Create openings

Determine where you want to install the Powerdaylight system from the inside and mark the position through the roof.

Note: Consider the roof construction and any electrical wires or pipes which may be hidden within the roof void.

Make a neat, round opening with the diameter below in the roof construction.

Powerdaylight 25 cm: between \varnothing 270 - \varnothing 280 mm

Powerdaylight 35 cm: between \varnothing 370 - \varnothing 380 mm

Powerdaylight 53 cm: \varnothing 550 mm

For a round ceiling diffuser, the opening in the ceiling must be made with the same diameter as mentioned above.

For a square ceiling diffuser, a neat, square opening must be made in the ceiling with the dimensions below:

Powerdaylight 25 cm Justfrost:	267 x 267 mm
Powerdaylight 25 cm Recessed:	245 x 245 mm
Powerdaylight 35 cm Justfrost:	367 x 367 mm
Powerdaylight 35 cm Recessed:	345 x 345 mm
Powerdaylight 53 cm Square:	605 x 605 mm
Powerdaylight 53 cm Recessed:	568 x 568 mm

Step 2 – Fit the flashing insulator

Degrease the underside of the roof flashing. Centre the flashing insulator over the underside of the roof flashing and tape it into position with the aluminium tape provided as shown below.

Note: The flashing insulator is an important part to prevent thermal bridging!

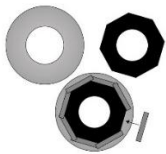

Step 3 – Mount the roof flashing

Centre the roof flashing over the opening created and secure the flashing down with suitable screws (not supplied). Apply the appropriate roofing material over the flange of the flashing, ensuring a

watertight seal. Optional ready-made counter flashings are available for various roof covering types (SBS bitumen, Resitrix EPDM or European EPDM) at an additional cost.

Step 4 – Install system through roof flashing

Tip: Remove the transparent protective film from the inside of the tubing, as it is easier than doing it later from below. If you have chosen the 'round ceiling diffuser (no ceiling)', this is often already pre-fitted and therefore the protective film has already been removed!

Carefully push the exterior tube down through the roof flashing and flashing insulator (this is a tight fit as the insulator seals hermetically around the tube) until the aluminium dome ring is correctly seated down over the top collar of the roof flashing.

Please note: With the ECO version, the tube must be completely insulated. We recommend doing this in advance with an insulation foil such as Alkreflex. This insulation foil is not included as standard.



Including round ceiling diffuser (no ceiling)

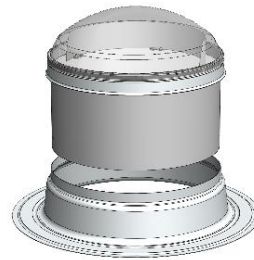

excluding ceiling diffuser



Make sure that the aluminium dome ring slides completely over the collar of the roof flashing!

Step 5 – Orientate the dome reflector

The dome reflector must be orientated with the reflective side (the concave side) facing towards the south and the convex side towards the north. As an exception, in the case of an obstacle such as an extending wall, the wall can be considered as the 'north side', therefore the convex side is directed towards the wall. The exterior tube can be twisted within the roof flashing to the correct orientation.



Step 6 – Fix the roof dome

Screw the 3 fixing screws supplied through the aluminium dome ring in 3 places around the ring as indicated below. The screws will pierce through both the roof flashing and the reflective tubing.

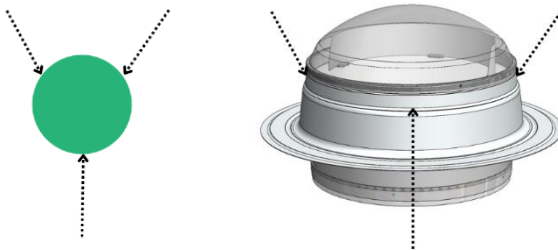

Continuation of the installation instructions:

For the remaining installation instructions (interior tube and ceiling diffuser) we refer you to the separate installation instructions for the specific chosen ceiling diffuser type. If we were informed of the desired system length in advance, the ceiling diffuser would have been provided pre-assembled to the tubing, therefore in this case the installation is now complete.